

Modular Generator Panel



MGC920

- Select AC Meter Module Only or Add Engine Module for Manual or Auto Start
- Compact
- Full Featured
- Modular

The MGC920 series Modular Generator Panel allows you to select an AC meter module only or add an engine module for manual or automatic start. It is suitable for 1-phase, 3-wire or 3-phase, 4-wire generators. Current transformers (CT's) are not included.

AC Meter Module

- AC voltmeter, 3-1/2 in (89 mm) dial, $\pm 2\%$ full scale (specify range).
- AC ammeter, 3-1/2 in (89 mm) dial, $\pm 2\%$ full scale (specify range).
- AC frequency meter, 120 V, 3-1/2 in (89 mm) dial, ± 0.6 Hz, pointer type, 45-65 Hz.
- Frequency meter rheostat.

Optional Engine Module

- **Auto-start Module Panel** can be bolted to the AC module to provide automatic engine control capabilities. The auto-start panel includes the following features.
 - ASM150, auto-start controller with:
 - Optically isolated noise resistant inputs.
 - 300 mA transistor output for fault annunciator/TATTLETALE®.
 - Crank/rest cycle timer, 4 to 25 seconds (adjustable).
 - Shutdown time delay, 1 to 25 seconds (adjustable), locks out low oil pressure and high temperature on start-up.

- Crank disconnect and overspeed sensing switches that operate from a magnetic pickup signal, (requires 2 Vrms minimum).
- Auxiliary starter relay.
- Oil pressure SWICHGAGE®, 2 in (51 mm) dial, 0-100 psi (0-689 kPa).
- Temperature SWICHGAGE®, 2 in (51 mm) dial, 70-230°F (21-110°C), 12 ft. (3.7 m) capillary.
- TEST-OFF-AUTO selector switch.
- Two (2) 2-1/16 in. (51 mm) diameter holes, plugged.
- **Manual Start Module Panel** can be bolted to the AC module to provide manual start engine control. The manual start panel includes the following features.
 - Power OFF-ON toggle switch and start push button.
 - 518APH TATTLETALE® annunciator.
 - Auxiliary starter relay.
 - Oil Pressure SWICHGAGE®, 2 in (51 mm) dial, 0-100 psi (0-689 kPa).
 - Temperature SWICHGAGE®, 2 in (51 mm) dial, 70-230°F (21-110°C), 12 ft. (3.7 m) capillary.
 - Two (2) 2-1/16 in. (52 mm) diameter holes, plugged.

Options

- AC ammeter-voltmeter phase selector switch. Requires 2 additional CT.
- AC instrument circuit breaker (in lieu of fuses).
- Hourmeter, 2 in. (51 mm) dial, 5-digit.
- Battery voltmeter, 2 in (51 mm) dial (range determined by battery voltage).
- Battery ammeter, 2 in (51 mm), 60-0-60.
- Air dampener closed relay.
- Glow plug module.
- 14 x 12 in. (343 x 305 mm) weathertight enclosure.

Warranty

A two-year limited warranty on materials and workmanship is given with this Murphy product. Details are available on request and are packed with each unit.

Dimensions

MGC920 Standard Enclosure

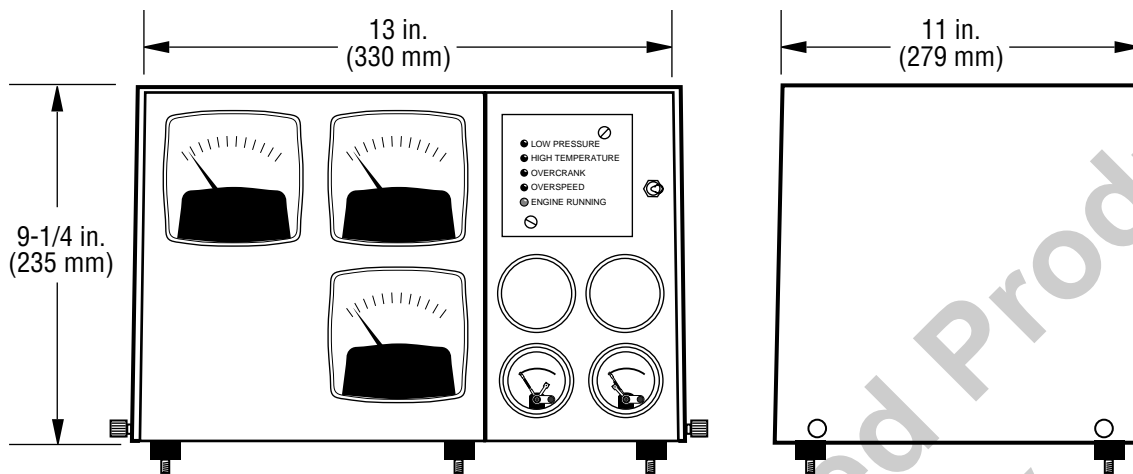

MGC920 Weathertight Enclosure

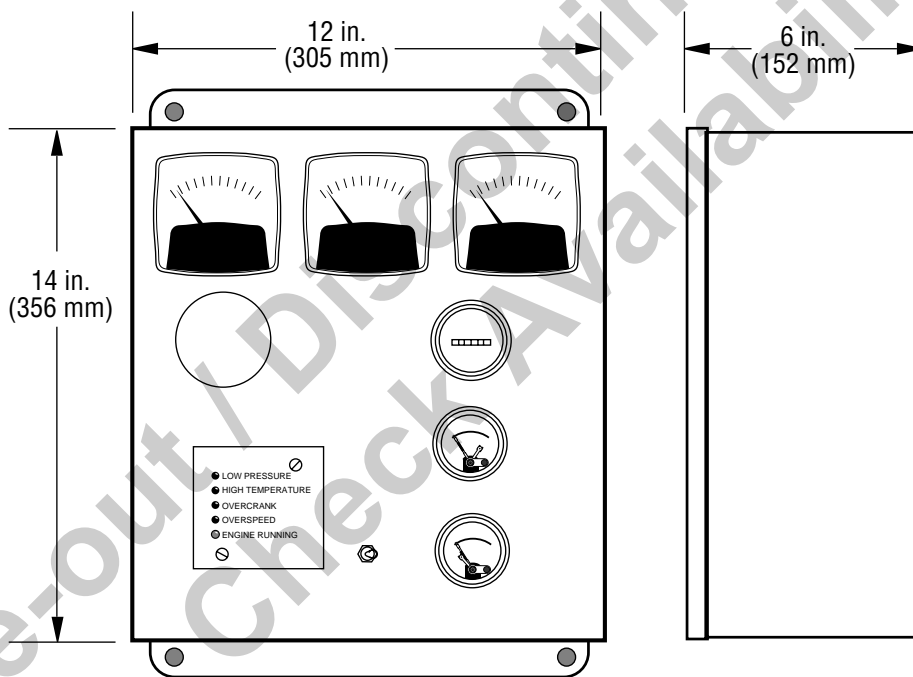

To order the MGC920, see "MGC920 Specification and Ordering Information" manual.